

15

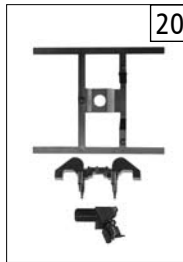

20



17

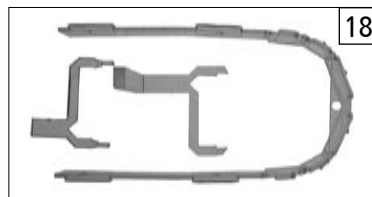

18



13

21



5

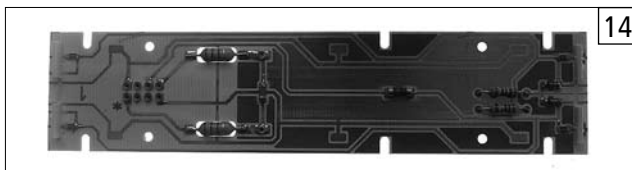

14

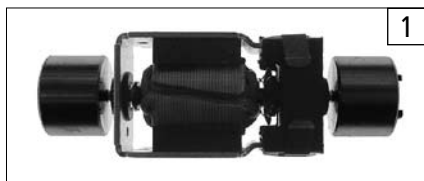

1



6



16

3



11

| Pos. Nr. Pos.no. | Beschreibung Description | Art.-Nr. Art.no. | Preisgruppe Price bracket |
|--------------------------|---|---------------------|------------------------------|
| 62676 | NS 1000 | ≡ | |
| 68676 | | ~ | |
| 1 | Motor kpl. Motor ass. | 85146 | 57 |
| 2 | Stromabnehmer NS Pantograph NS | 85486 | 39 |
| 3 | Schraube M2x4 Screw M2x4 | 85670 | 2 |
| 4 | Schraube M2x6 Screw M2x6 | 85672 | 2 |
| 5 | Schraube M2,2x9,5 Screw M2,2x9,5 | 85808 | 2 |
| 6 | Kardanhülse Cardan shell | 87024 | 2 |
| 7 | Pantographen Isolator Insulator for pantograph | 88146 | 2 |
| 8 | Puffer flach Buffer flat | 88600 | 3 |
| 9 | Puffer gewölbt Buffer vaulted | 88601 | 3 |
| 10 | E-Lokführer blau E-loco driver blue | 89725 | 5 |
| 11 | Radkontakt gebogen Wheel contact | 89915 | 5 |
| 12 | Steuerrad Steering wheel | 94712 | 2 |
| 13 | Brückenstecker mit Kondensator Connector w. capacitor | 125666 | 12 |
| 14 | Platine kpl. Printed circuit ass. | 127389 | 57 |
| 15 | Gehäuse kpl. Betr.nr. 1002 Body ass. loco no. 1002 | 131061 | 70 |
| 16 | Motorträger Motor holder | 127394 | 7 |
| 17 | Führerstandsatz Drivers cab set | 127399 | 10 |
| 18 | Fenster + Lichtleitersatz Part set window a. lighttransmission bar | 127400 | 10 |
| 19 | Stromabnehmer-Leitung Pantograph line | 130761 | 3 |
| 20 | TS - Gehäuse Part set body | 131062 | 10 |
| AC - Wechselstrom | | | |
| 21 | Decoder Decoder | 10732 | --- |

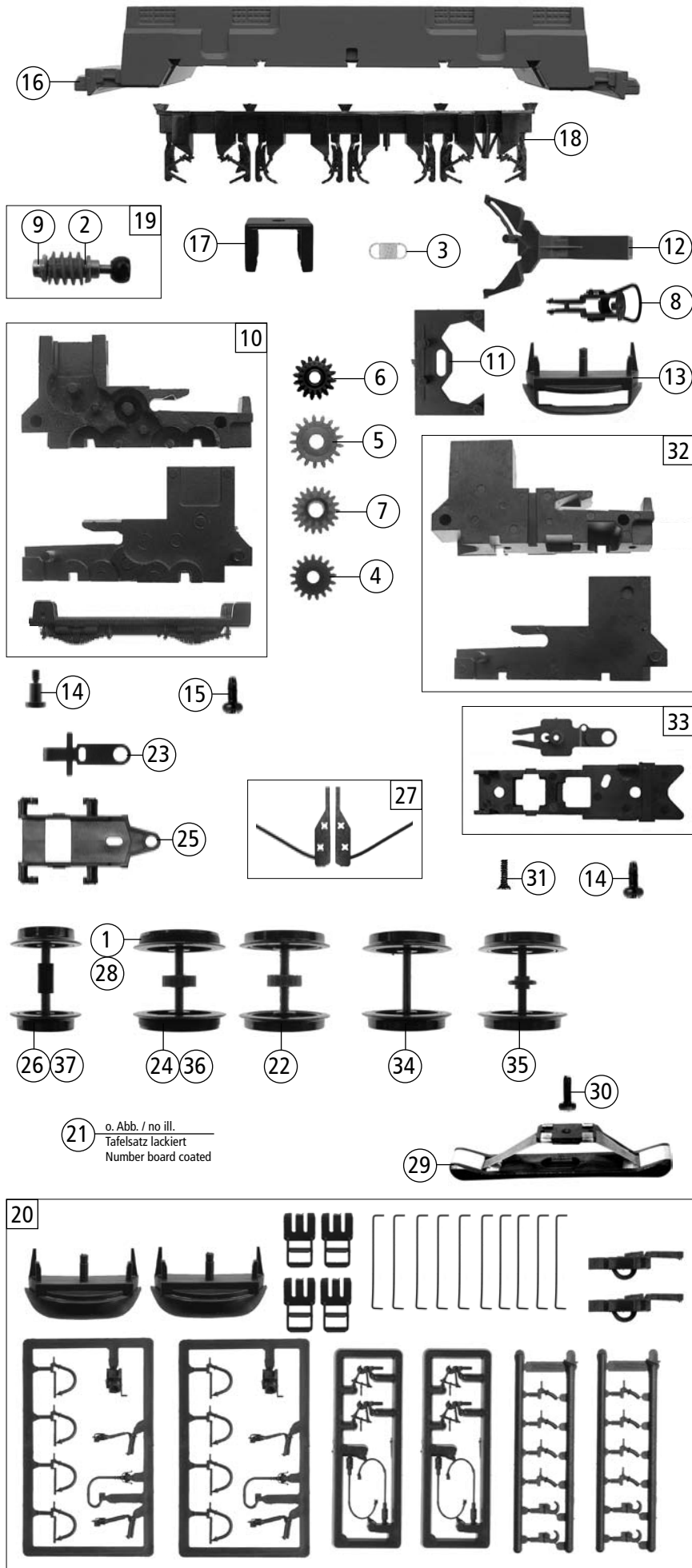

| Pos. Nr. Pos.no. | Beschreibung Description | Art.-Nr. Art.no. | Preisgruppe Price bracket |
|--------------------------|---|---------------------|------------------------------|
| 62676 | NS 1000 | | |
| 68676 | | ~ | |
| 1 | Haftringsatz 10Stk. 16,8-19mm Set w. traction tiers 10pieces 16,8-19mm | 40078 | --- |
| 2 | Beilagscheibe 2,1x4 / 0,2 mm Washer | 86108 | 2 |
| 3 | Feder Spring | 86208 | 2 |
| 4 | Zahnrad Z=17 Gear Z=17 | 86409 | 2 |
| 5 | Zahnrad Z=17 0.4G Gear Z=17 0.4G | 86418 | 2 |
| 6 | Schnecken Zahnrad Worm gear | 86419 | 4 |
| 7 | Zahnrad Z=19/12 Gear Z=19/12 | 86424 | 3 |
| 8 | Standardkupplung komplett Standard coupling ass. | 89246 | 5 |
| 9 | Lager für Schneckenachse Bearing for worm axle | 89749 | 6 |
| 10 | Getriebe-Teilesatz Part set gear | 94686 | 35 |
| 11 | Abdeckplatte Cover | 94745 | 5 |
| 12 | Kupplungsdeichsel schwarz Coupler drawbar | 94746 | 5 |
| 13 | Schürze offen Apron open | 131060 | 5 |
| 14 | Ansatzschraube 2X4 Screw 2x4 | 108167 | 3 |
| 15 | GF-Schraube M2x5 GF-Screw M2x5 | 114966 | 2 |
| 16 | Grundrahmen Base frame | 127386 | 32 |
| 17 | Schneckendeckel worm cover | 127387 | 4 |
| 18 | Bremsleiste Brake ledge | 127388 | 12 |
| 19 | Schneckensatz Worm set | 127390 | 24 |
| 20 | Zurüstbeutel Bag w. accessories | 131064 | 24 |
| 21 | Tafelsatz lackiert o. Abb. Numberboard set coated no ill. | 131065 | 18 |
| 22 | Radsatz ohne Haftring Wheelset without traction tiers | 127395 | 18 |
| 23 | Vorlaufgestellfeder Spring | 127396 | 3 |
| 24 | Radsatz m. 2 Haftr. m. Zahnrad Wheelset w. traction tiers w. gear | 127397 | 20 |
| 25 | Vorlaufdeichsel Drawbar | 127402 | 5 |
| 26 | Vorlaufradsatz Wheelset | 127403 | 16 |
| 27 | Vorlaufradkontaktsatz li+re Contact set left a. right | 127404 | 7 |
| AC - Wechselstrom | | | |
| 28 | Haftrings.10Stk.17,5-20mm Set w. traction tiers 10pieces 17,5-20mm | 40077 | --- |
| 29 | Schleifer 42mm Slider 42mm | 86030 | 26 |
| 30 | GF-Schraube M1,6x4 GF-Screw M1,6x4 | 114850 | 2 |
| 31 | SK-Schraube M2x4 SK-Screw M2x4 | 115541 | 2 |
| 32 | TS - Getriebe Part set gear | 127405 | 18 |
| 33 | Getriebeboden + Schleiferträge Gear bottom w. slider holder | 127406 | 12 |
| 34 | Radsatz ohne Haftring Wheelset without traction tiers | 127407 | 16 |
| 35 | Radsatz mit Mitnehmer Wheelset w. | 127408 | 18 |
| 36 | Radsatz mit 2 Haftringen m. Zahnrad Wheelset w. traction tiers w. gear | 127409 | 20 |
| 37 | Vorlaufradsatz Inducer set | 127410 | 16 |

Ersatzteile erhalten Sie bei Ihrem Fachhändler, oder Ihrer Landesvertretung:
You can order your Replacement Parts at your local dealer, your country representative: