

| 62751               |  | DB                  | V 100                        | ≡ |  |
|---------------------|--|---------------------|------------------------------|---|--|
| Pos. Nr.<br>Pos.no. | Beschreibung<br>Description  | Art.-Nr.<br>Art.no. | Preisgruppe<br>Price bracket |   |  |
| 1                   | Kardanschale kurz<br>Cardan shell short                                  | 87129               | 4                            |   |  |
| 2                   | Antenne<br>Antenna   | 88030               | 5                            |   |  |
| 3                   | E-Lokführer<br>E-LoCo driver   | 89732               | 6                            |   |  |
| 4                   | Dach<br>Roof   | 94755               | 7                            |   |  |
| 5                   | Führerstand<br>Drivers cab   | 94756               | 6                            |   |  |
| 6                   | Fenster für Kabine<br>Cabine window                                      | 94758               | 8                            |   |  |
| 7                   | Lichtleiter vorne weiss<br>Front light transmission white                | 94759               | 5                            |   |  |
| 8                   | Lichtleiter hinten weiss<br>Rearlight transmission white                 | 94760               | 5                            |   |  |
| 9                   | Lichtleiter vorne rot<br>Front light transmission red                    | 94761               | 5                            |   |  |
| 10                  | Lichtleiter hinten rot<br>Rear light transmission red                    | 94762               | 5                            |   |  |
| 11                  | Puffer flach<br>Buffer flat  | 101351              | 4                            |   |  |
| 12                  | Puffer gewölbt<br>Buffer vaulted   | 101352              | 4                            |   |  |
| 13                  | Schienenräumer<br>Pilot frame  | 101356              | 4                            |   |  |
| 14                  | Drahtlampe 16V<br>Light bulb 16V   | 109321              | 8                            |   |  |
| 15                  | Motor<br>Motor   | 113092              | 28                           |   |  |
| 16                  | Steuerrad<br>Steering wheel  | 113975              | 3                            |   |  |
| 17                  | GF-Schraube M2x5<br>GF-Screw M2x5  | 114966              | 3                            |   |  |
| 18                  | Motordistanzplatte<br>Spacer   | 117202              | 3                            |   |  |
| 19                  | Grundrahmen<br>Main frame  | 120300              | 19                           |   |  |
| 20                  | Dekoderdeckel<br>Decoder cover   | 132041              | 4                            |   |  |
| 21                  | Platine komplett<br>Printed circuit assembly                             | 132042              | 26                           |   |  |
| 22                  | Lichtdecoder<br>Light decoder  | 132043              | 34                           |   |  |
| 23                  | Gehäuse komplett Betr. Nr. V 100 2027<br>Body completely no. V 100 2027  | 132045              | 24                           |   |  |
| 24                  | Kabine komplett Betr. Nr. V 100 2027<br>Cabine completely no. V 100 2027 | 132046              | 21                           |   |  |

Änderungen in Konstruktion und Ausführung vorbehalten  
We reserve the right to change the construction and specification

| 62751               |  | DB                  | V 100                        | == |
|---------------------|--|---------------------|------------------------------|----|
| Pos. Nr.<br>Pos.no. | Beschreibung<br>Description  | Art.-Nr.<br>Art.no. | Preisgruppe<br>Price bracket |    |
| 1                   | Hafringsatz 10Stk. 8,3-10,2mm<br>Set with traction tires 10 pieces                 | 40068               | ---                          |    |
| 2                   | Schraube M2x16<br>Screw M2x16  | 115094              | 3                            |    |
| 3                   | FK-Schraube mit Gewindeauslauf<br>FK-Screw with back taper thread                  | 85704               | 4                            |    |
| 4                   | Beilagscheibe 2,1x4/0,2mm<br>Washer 2,1x4/0,2                                      | 86108               | 3                            |    |
| 5                   | Feder<br>Spring  | 86202               | 3                            |    |
| 6                   | Schneckenzahnrad doppelt<br>Gear double  | 86419               | 6                            |    |
| 7                   | Zahnrad Z=19/12 M 0.4<br>Gear Z=19/12 M 0.4  | 86424               | 4                            |    |
| 8                   | Zahnrad Z=18 gerade M=0.4<br>Gear Z= 18 straight line M=0.4                        | 86460               | 3                            |    |
| 9                   | Zahnrad Z=12/ M 0.4<br>Gear Z=12/ M 0.4  | 86471               | 3                            |    |
| 10                  | Schneckensatz komplett<br>Worm set completely                                      | 86868               | 13                           |    |
| 11                  | Gelenkwelle<br>Cardan shaft  | 87138               | 4                            |    |
| 12                  | Standardkupplung<br>Standard coupling  | 89246               | 6                            |    |
| 13                  | Lager für Schneckenachse<br>Bearing for worm axle                                  | 89749               | 6                            |    |
| 14                  | Radkontakt<br>Wheelset   | 89879               | 6                            |    |
| 15                  | Radsatz ohne Hafring mit Zahnrad<br>Wheelset without traction tires with gear      | 90474               | 11                           |    |
| 16                  | Schneckendeckel<br>Worm cover  | 94707               | 4                            |    |
| 17                  | Drehgestellblende kurzer Vorbau komplett<br>Bogie frame short front end completely | 94773               | 12                           |    |
| 18                  | Bremsbackensteckteile<br>Brake shoe  | 94775               | 4                            |    |
| 19                  | Getriebebesatz ohne Zahnräder<br>Gear set without gears                            | 100042              | 13                           |    |
| 20                  | Drehgestellsteckteile<br>Bogie push in part  | 107102              | 4                            |    |
| 21                  | Radsatz mit 2 Hafringen<br>Wheelset with 2 traction tires                          | 107388              | 12                           |    |
| 22                  | Attrappenrahmen klein<br>Push in part set, small                                   | 107808              | 4                            |    |
| 23                  | Drehgestellbl. langer Vorbau komplett<br>Bogie frame long front end completely     | 115415              | 12                           |    |
| 24                  | Aufstiegsatz<br>Rear ladder set  | 120303              | 8                            |    |
| 25                  | Zurüstbeutel<br>Bag with accessories   | 200101              | 13                           |    |

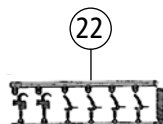
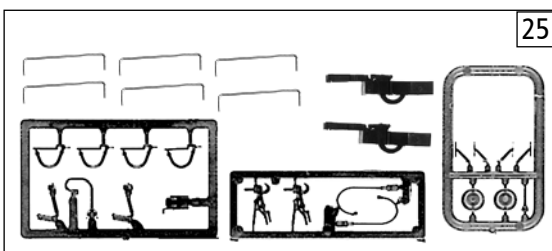
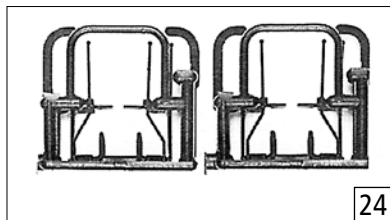
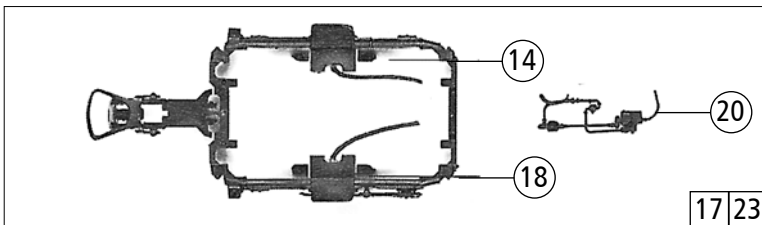
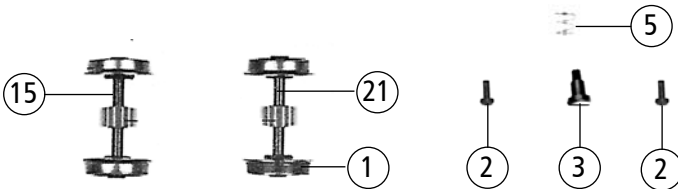
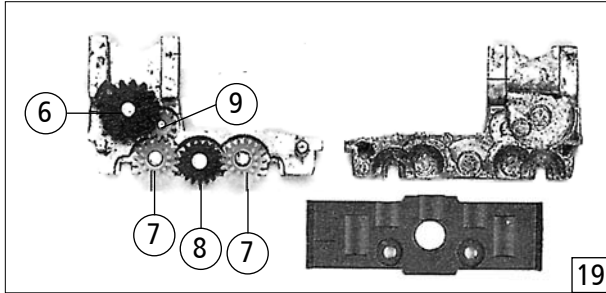
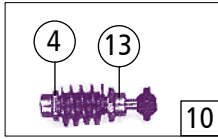

Ersatzteile erhalten Sie bei Ihrem Fachhändler,  
oder Ihrer Landesvertretung.

You can order your Replacement Parts at your local  
dealer, your country representative.