

24 o. Abb. / no ill.
Griff
Handrail

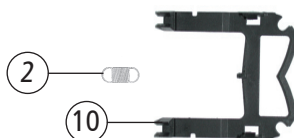

Pos. Nr. Pos.no.	Beschreibung Description	Art.-Nr. Art.no.	Preisgruppe Price bracket
62858	DSB My 1108	≡	
68858		~	
1	Motor komplett Motor	85112	57
2	Zugfeder Spring	86208	2
3	Kardanschale kurz 1,5mm Cardan shell short 1,5mm	87129	3
4	Platine komplett Printed circuit assembly	127562	38
5	Brückenstecker Connector	100644	7
6	Kardanwelle Cardan Shaft	105906	3
7	Drahtlampe T1 16V/30mA Light bulb T1 16V/30mA	109321	10
8	Lampenhalter Lamp holder	109879	2
9	Grundrahmen Main frame	113686	30
10	Kinematik Kinematics	113687	3
11	Motordistanzplättchen Motor spacer	113690	2
12	Lampen-Flexplatine Flexible printed circuit for bulbs	113691	26
13	Fenster-Linsensatz Window-light transmission set	115576	16
14	Führerstand kpl. Drivers cab assembly	113699	10
15	Ts.-Gehäuse+Drehgestell Parts set body shell and bogie	113700	14
16	Scheibenwischersatz Set of windscreen wiper	113949	6
17	Puffer flach Buffer flat	113702	2
18	Puffer gewölbt Buffer vaulted	113703	2
19	Kontaktfeder Contact spring	116876	2
20	GF-Schraube M2X5 GF-Screw M2X5	114966	2
21	Schneckendeckel Wormcover	121285	3
22	Antenne Antenna	114007	2
23	Gehäuse kpl. Betr. Nr. My 1108 Body shell assembly no. My 1108	129623	68
24	Griff Handrail	115578	2
AC-Wechselstrom			
25	Decoder Decoder	10732	---

Änderungen in Konstruktion und Ausführung vorbehalten
We reserve the right to change the construction and specification

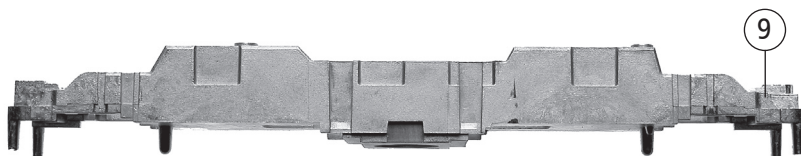
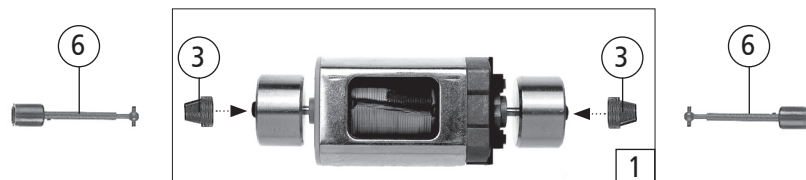
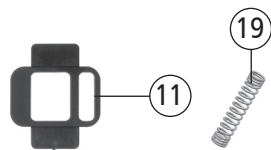
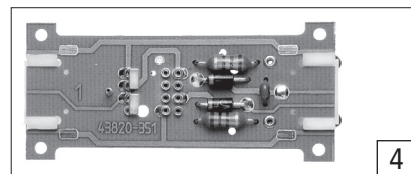
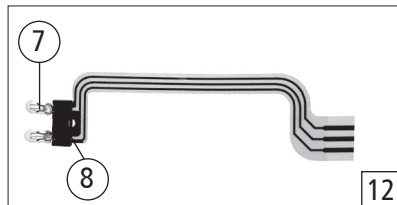
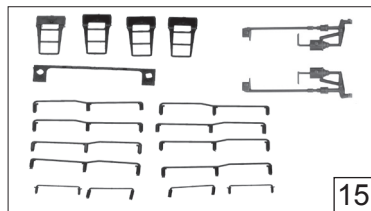
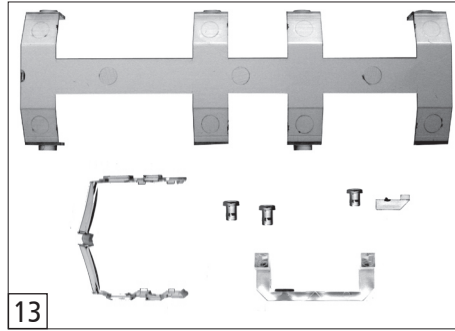
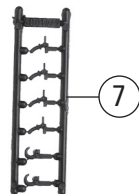
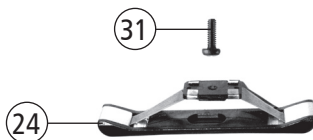
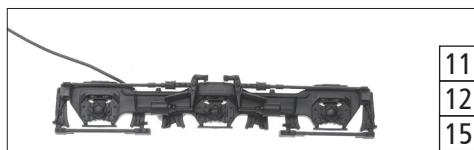
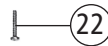
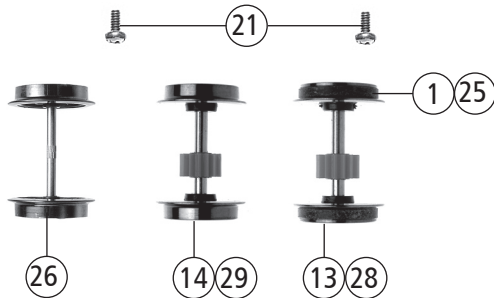
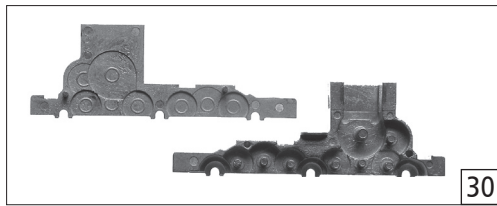
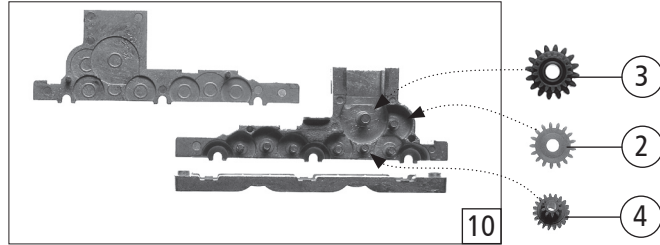
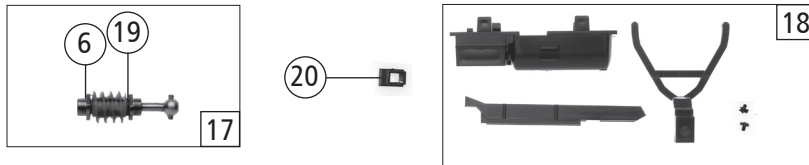

Pos. Nr. Pos.no.	Beschreibung Description	Art.-Nr. Art.no.	Preisgruppe Price bracket
62858	DSB My 1108	=	
68858		~	
1	Hafrings.10Stk.10,3-12,8mm Set with traction tires 10 pieces	40069	---
2	Zahnrad Z=17/0.4 G Gear Z=17/0.4 G	86418	4
3	Schnecken Zahnrad doppelt Worm gear	86419	5
4	Zwischenzahnrad Between gear	86480	2
5	Standardkupplung Coupling standard	89246	5
6	Lager für Schneckenachse Bearing for worm axle	89749	6
7	Attrappenrahmen klein Push in part set, small	107808	3
8	Zubehör Rahmensatz Parts set	108322	8
9	Schienenräumer Snow plug	129622	9
10	Teilesatz Getriebe Gear parts set	113692	24
11	Blende kpl. vorne rechts/hinten links Bogie assembly front right/behind left	113693	17
12	Blende kpl. hinten rechts Bogie assembly behind right	113694	17
13	Radsatz mit 2 Hafringen Wheelset with 2 traction tires	113695	20
14	Radsatz ohne Hafring Wheelset without traction tires	113696	18
15	Blende kpl. links vorne Bogie assembly left front	113697	17
16	Radkontakt lochdurchm. 1,3 Wheel contact 1,3	113704	2
17	Schneckensatz Worm set	113705	24
18	Teilesatz Drehgestell Parts set bogie	113689	8
19	Anlaufscheibe 4x2,1x0,1 Washer 4x2,1x0,1	113942	2
20	Adapter Adaptor	114004	3
21	GF-Schraube M2x6 GF-screw M2x6	114828	2
22	GF-Schraube 1,6x4 GF-screw 1,6x4	114850	2
23	Zurüstbeutel Bag with accessories	129624	20
AC-Wechselstrom			
24	AC-Schleifer 42mm AC wiper 42mm	86030	26
25	Hafrings.10Stk. 10,3-12,4mm Set with traction tires 10 pieces10,3-12,4	40074	---
26	Radsatz ohne Zahnrad Wheelset without gear	112685	16
27	Getriebeboden AC Gear bottom AC	113708	6
28	Radsatz mit 2 Hafringen Wheelset with 2 traction tires	113709	20
29	Radsatz ohne Hafring Wheelset without traction tires	113710	18
30	Getriebeteilesatz AC Gear set AC	113711	18
31	GF-Schraube M1,6x6 GF-screw M1,6x6	114836	2

Ersatzteile erhalten Sie bei Ihrem Fachhändler, oder Ihrer Landesvertretung:
You can order your Replacement Parts at your local dealer, your country representative: