

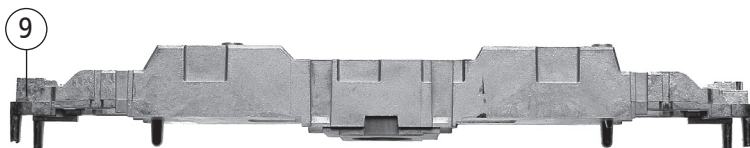

62952	NSB	Di 3b	
68952			~

Pos. Nr. Pos.no.	Beschreibung Description	Art.-Nr. Art.no.	Preisgruppe Price bracket
1	Motor Motor	85112	57
2	Zugfeder Spring	86208	2
3	Kardanschale kurz 1,5mm Cardan shell short 1,5mm	87129	3
4	Platine komplett Printed circuit assembly	127562	38
5	Brückenstecker Connector	100644	7
6	Kardanwelle Cardan shaft	105906	3
7	Drahtlampe T1 16V/30mA Light bulb T1 16V/30mA	109321	10
8	Lampenhalter Lamp holder	109879	2
9	Grundrahmen Main frame	113686	30
10	Kinematik Kinematics	113687	3
11	Motordistanzplättchen Motor spacer	113690	2
12	Lampen-Flexplatine Flexible Printed circuit for bulbs	113691	26
13	Führerstand kpl. Drivers cab assembly	113699	10
14	TS-Gehäuse und Drehgestell Parts set body and bogie	113700	14
15	Puffer flach Buffer flat	113702	2
16	Puffer gewölbt Buffer vaulted	113703	2
17	Schneckendeckel Wormcover	108594	5
18	Kontaktfeder Contact spring	116876	2
19	Scheibenwischersatz Set of windscreen wiper	113949	6
20	GF-Schraube M2X5 GF-Screw M2X5	114966	2
21	Fenster-Linsensatz Window-light transmission set	113698	16
22	Gehäuse kpl. Betr.nr. NOHAB-GM Body ass. loco no. NOHAB-GM	130721	66
AC-Wechselstrom			
23	Decoder Decoder	10732	---

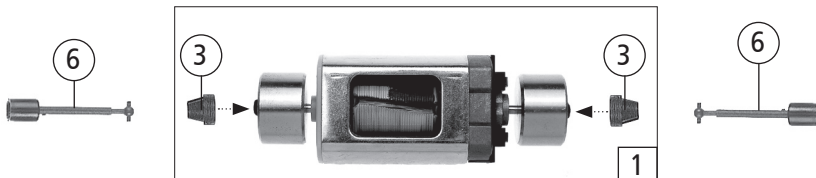
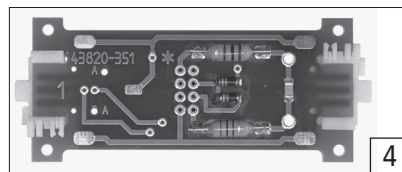
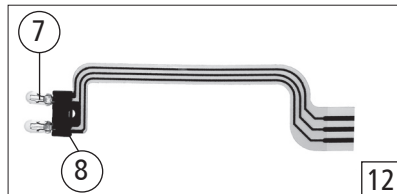
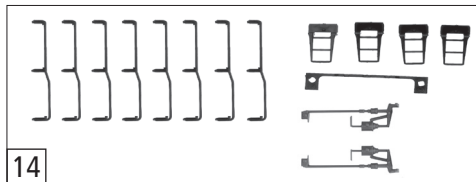
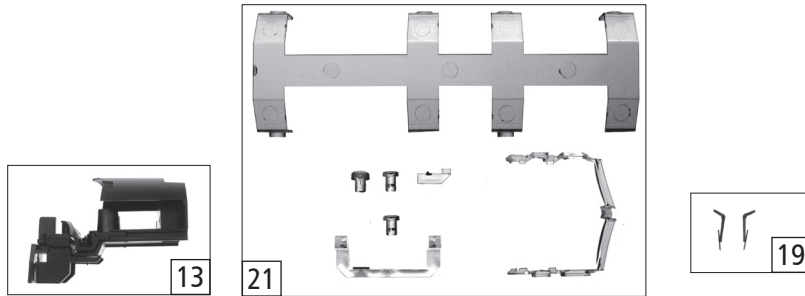

Änderungen in Konstruktion und Ausführung vorbehalten
We reserve the right to change the construction and specification

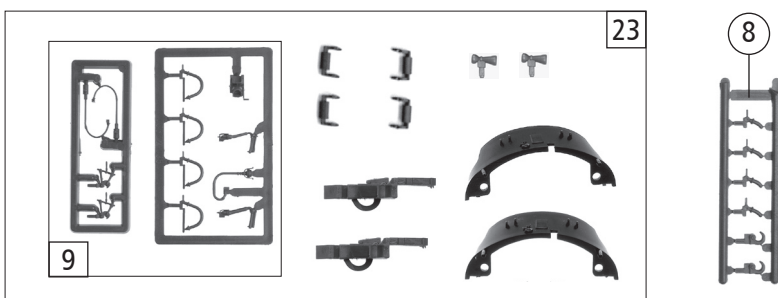
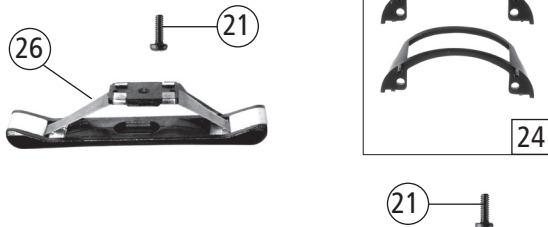
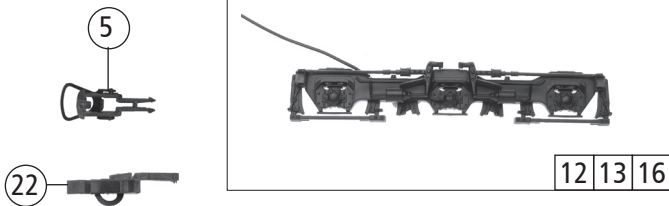
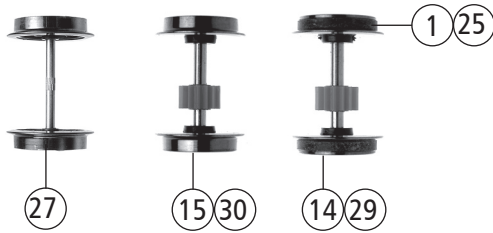
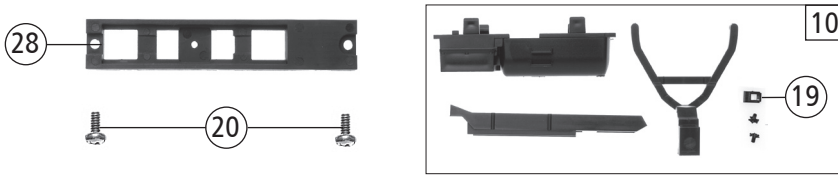
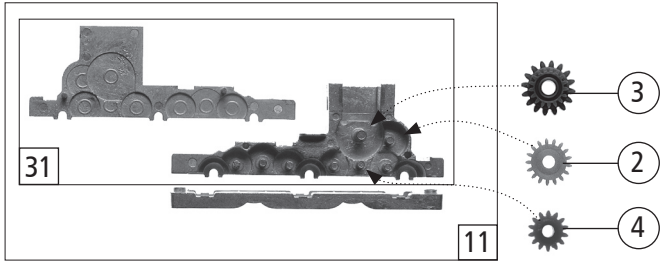
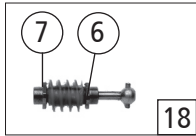

62952	NSB	Di 3b	
68952			~

Pos. Nr. Pos.no.	Beschreibung Description	Art.-Nr. Art.no.	Preisgruppe Price bracket
1	Hafrings.10Stk.10,3-12,8mm Set with traction tires 10 pieces	40069	---
2	Zahnrad Z=17/0.4 G Gear Z=17/0.4 G	86418	4
3	Schneckenzahnrad doppelt Worm gear	86419	5
4	Zwischenzahnrad Z=14 Between gear Z=14	86480	2
5	Standardkupplung kpl. Standard coupling	89246	5
6	Scheibe Washer	113942	2
7	Lager für Schneckenachse Bearing for Worm axle	89749	6
8	Attrappenrahmen klein Push in part set, small	107808	3
9	Zubehörhemensatz Parts set	108322	8
10	Teilesatz Drehgestell Parts set bogie	113689	8
11	Teilesatz Getriebe Gear parts set	113692	24
12	Blende vorne re./ hinten li. Bogie cover front right/behind left	113693	17
13	Blende hinten rechts Bogie cover behind right	113694	17
14	Radsatz mit 2 Hafringen Wheelset with 2 traction tires	113695	20
15	Radsatz ohne Hafring Wheelset without traction tires	113696	18
16	Blende vorne links Bogie front left	113697	17
17	Radkontakt lochdurchm. 1,3. Wheel contact 1,3	113704	2
18	Schneckensatz Worm set	113705	24
19	Adapter Adaptor	114004	3
20	GF-Schraube M2x6 GF-Screw M2x6	114828	2
21	GF-Schraube M1,6X6 GF-Screw M1,6x6	114836	2
22	Kurzkupplung-Vorentkupplung Coupling short	115550	5
23	Zurüstbeutel Bag w. accessories	130722	21
24	TS-Schienenräumer Part set snow plough	130723	7
AC-Wechselstrom			
25	Hafrings.10Stk. 10,3-12,4mm Set with traction tires 10 pieces10,3-12,4	40074	---
26	Schleifer Slider	86030	26
27	Radsatz ohne Zahnrad Wheelset without Gear	112685	16
28	Getriebeboden AC Gear bottom AC	113708	6
29	Radsatz mit 2 Hafringen Wheelset with 2 traction tires	113709	20
30	Radsatz ohne Hafring Wheelset without traction tires	113710	18
31	Getriebebesatz AC 2-teilig Gear set AC 2-parts	113711	18

Ersatzteile erhalten Sie bei Ihrem Fachhändler, oder Ihrer Landesvertretung:
You can order your Replacement Parts at your local dealer, your country representative: